

James Pugh's Land.

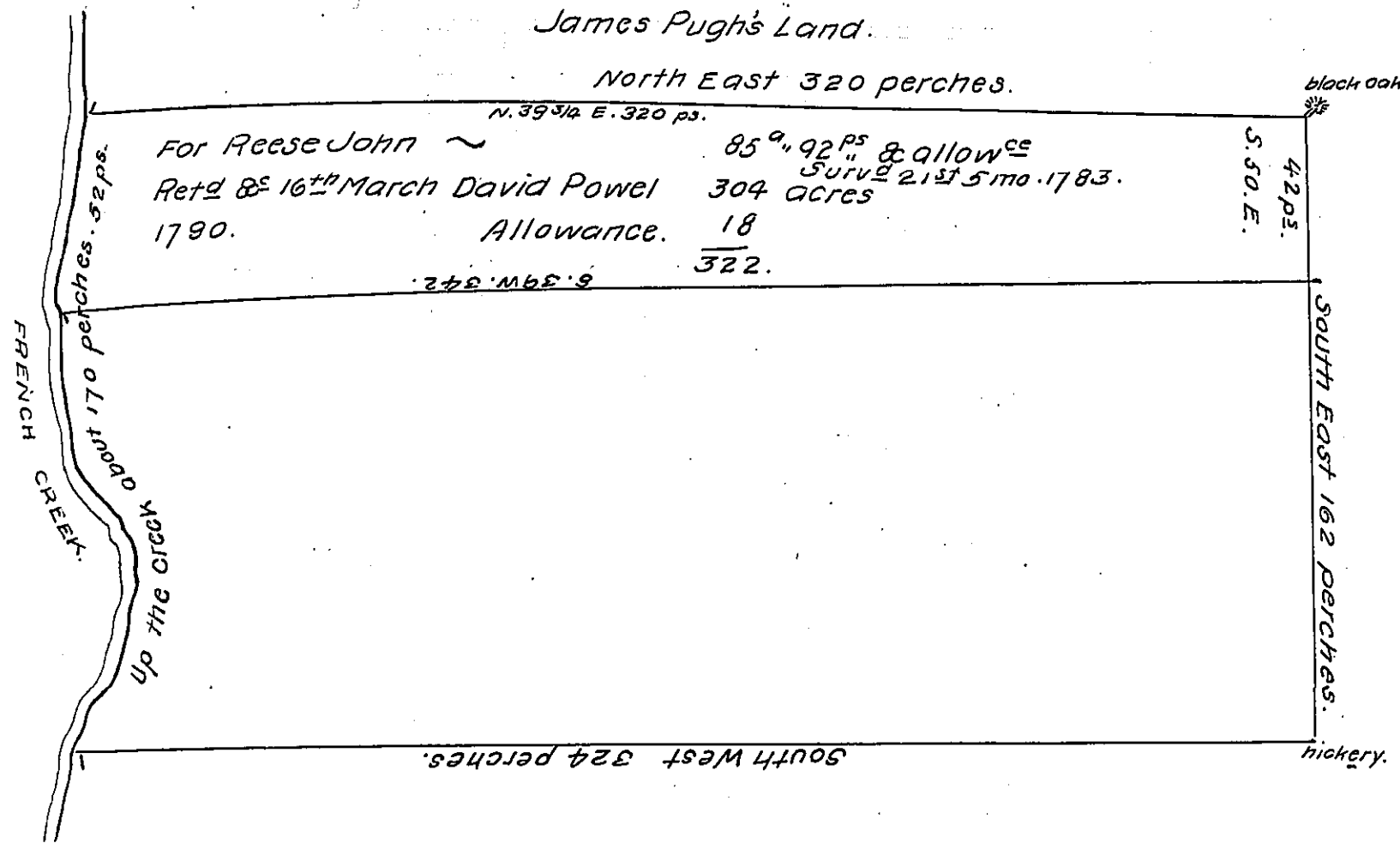

By virtue of a warrant from the Commissioners of Property dated the 10<sup>th</sup> day of September in the year 1727<sup>(obl. -)</sup> for surveying to David Powel of Philadelphia Surveyor Three thousand acres of land in this Province This may certifie that on the 25<sup>th</sup> day of May in the year 1727 I Surveyd to the said David Powel the Remainder of the said quantity being three hundred and four acres in the County of Chester beginning in a Line of James Pugh's land on the North East side of French Creek Thence running North East by the said James Pugh's land three hundred and twenty perches to a corner marked black Oak Then South East by a line of marked trees One hundred Sixty two perches to a corner marked hickery Then by a line of Marked trees South West three hundred twenty four perches to the said Creek Then up the same on several Courses about One hundred & seventy perches to the place of Beginning containing three hundred & four acres with allowance of six per Cent.

Jacob Taylor.

IN TESTIMONY that the above is a copy of the original remaining on file in the Department of Internal Affairs of Pennsylvania, made conformably to an Act of Assembly approved the 16th day of February, 1833, I have hereunto set my Hand and caused the Seal of said Department to be affixed at Harrisburg, this third day of August, 1909.

*Henry Howard*  
 Secretary of Internal Affairs.